

DOME CAMERA

TDC-612SF/DV65

WDR/TDN/DNR/560TV LINES DOME CAMERA



- FEATURES -

- 1/3" SONY Double Scan CCD
- 560TV Lines Horizontal Resolution (B/W : 700TV Lines)
- Excellent Low Light Sensitivity of 0.3Lux/F1.2 (B/W : 0.01Lux)
- Sens-up : x256 (0.0001Lux)
- True Day & Night (ICR)
- WDR : Wide Dynamic Range (x128)
- DNR : Digital Noise Reduction
- DIS : Digital Image Stabilizer
- Motion Detection : 8 Zone, Alarm Output
- Privacy : 8 Zone
- x10 Digital Zoom
- OSD Menu Control by Push Button
- DC Varifocal ICR Lens f=6.0~50.0mm
- Ø120 Dome
- 3-Axis gimbal bracket

Option

- TDC-624SF/DV65 : Dual Voltage (AC24V / DC12V)

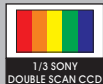

1/3 SONY
DOUBLE SCAN CCD

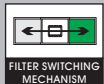

FILTER SWITCHING
MECHANISM



DAY & NIGHT



WDR
WIDE DYNAMIC
RANGE



DNR
DIGITAL NOISE
REDUCTION



SENS-UP
SENS-UP
0.0001 Lux



DIS
DIGITAL
IMAGE STABILIZER



AUTO IRIS



6.0-50.0mm
VARIFOCAL LENS



3-AXIS GIMBAL

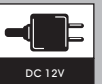

DC 12V

- DIMENSION -

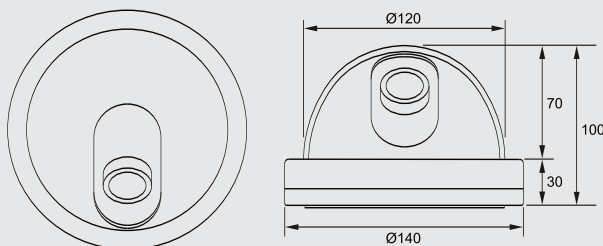

- 3 AXIS GIMBAL BRACKET -



- Camera Rotation : 360°
- Tilt Rotation : 100°
- Pan Rotation : 270°

- WALL MOUNT BRACKET -



MBR-120WM

- SPECIFICATIONS -

TDC-612SF/DV65		
Signal Format	NTSC	PAL
Horizontal Resolution	Color : 560TV Lines, B/W : 700TV Lines	
Image Sensor	1/3" SONY Double Scan CCD	
Total Pixels	811(H) x 508(V)	795(H) x 596(V)
Effective Pixels	768(H) x 494(V)	752(H) x 582(V)
Scanning System	2:1 Interface	
Synchronization	Internal	
Scanning Frequency	15.734 KHz(H), 59.94 Hz(V)	15.625 KHz(H), 50.00 Hz(V)
Video Output	CVBS : 1Vp-p/75Ω	
Min. Illumination	Color : 0.3Lux/F1.2, B/W : 0.01Lux, Sens-up : 0.0001Lux	
Electronic Shutter	1/60 ~ 1/120,000 sec	1/50 ~ 1/120,000 sec
IRIS Control	DC	
Signal to Noise Ratio	52dB (AGC Off, Weight On)	
Backlight Compensation	WDR / BLC / OFF	
White Balance	ATW / AWC / MANUAL / OUTDOOR (1,800°K ~ 10,500°K) / INDOOR (4,500°K ~ 8,500°K)	
Gain Control	LOW / HIGH / OFF	
Digital Noise Reduction	ON / OFF (1~32 Level Adjustable)	
Day & Night	COLOR / BLACK & WHITE(ICR) / AUTO / EXT	
Sens-up	AUTO / OFF (Selectable x2 ~ x256)	
Wide Dynamic Range	52dB (x128)	
Digital Image Stabilizer	ON / OFF	
Digital Zoom	ON (x2 ~ x10) / OFF	
Motion Detection	ON / OFF (8 Zone, Alarm Output)	
Privacy	ON / OFF (8 Zone)	
Mirror (H-REV)	ON / OFF	
Flip (V-REV)	ON / OFF	
Freeze	ON / OFF	
Sharpness	ON / OFF (Level Adjustable)	
OSD	Built-in (Chinese, English, French, German, Italian, Japanese, Korean, Spanish)	
Lens	DC Varifocal ICR Lens f=6.0-50.0mm	
Input Voltage	DC 12V (±10%)	
Power Consumption	Max. 2.4W	
Operating Temp/Hum	Temperature : -10°C to +50°C / Humidity : 30% to 80% RH	
Dimension	140(Ø) x 100(H)mm	
Weight	Approx. 400g	
Option	TDC-624SF/DV65 : Dual Voltage (AC24V / DC12V), Wall Mount Bracket	