

# TDE-214S

## 14 IR LED DOME CAMERA



Body Color : Black / White

### - FEATURES -

- 1/3" SONY DSP Super HAD CCD
- SONY SS-11RM Chipset
- 380TV Lines Horizontal Resolution
- 14pcs IR LED for night vision
- Visibility Range : 5~10m
- Auto White Balance
- Φ100 Dome size
- Board Lens : 3.6mm
- Vandal Proof Glass

### Option

- Board Lens : 6.0mm



1/3 SONY DSP Super HAD CCD



COLOR



3.6mm BOARD LENS



14pcs IR LED



DAY & NIGHT



AUTO-IRIS

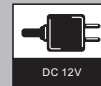

DC 12V

### - DIMENSION -

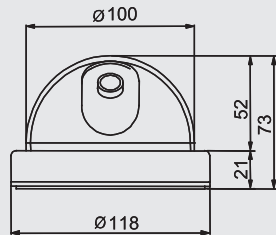
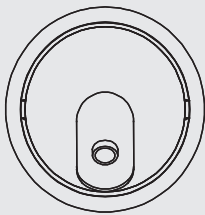

### - SPECIFICATIONS -

TDE-214S		
Signal Format	NTSC	PAL
Horizontal Resolution	380TV Lines	
Image Sensor	1/3" SONY DSP Super HAD CCD	
Synchronization	Internal	
Video Output	CVBS : 1.0Vp-p/75Ω	
Min. Illumination	IR LED Off 3Lux(COLOR), IR LED On (0.000Lux)	
Electronic Shutter	1/60~1/100,000 sec Auto	1/50~1/100,000 sec Auto
Signal to Noise Ratio	45dB or more (AGC Off)	
Gamma	0.45	
AGC	On	
Input Voltage	DC12V (±10%)	
Power Consumption	MAX 2.0W	
DIP Switch Control	AI/EE Mode, AGC on/off, Flicker less on/off Backlight compensation on/off	
Lens Option	6.0mm	
Operating Temperature	-10°C to +55°C	
Storage Temperature	-20°C to +70°C	
Operating Humidity	Under 90% Non-condensing	
Storage Humidity	Under 90% Non-condensing	
Dimension	Φ118 x 73(H)mm	
Weight	420g	