

## IR LED DOME CAMERA

# TDE-224S

## 24 IR LED DOME CAMERA



Body Color : Black / White

### - FEATURES -

- 1/3" SONY DSP Super HAD CCD
- SONY SS-11RM Chipset
- 380TV Lines Horizontal Resolution
- 24pcs IR LED for night vision
- Visibility Range : 10~15m
- Auto White Balance
- Φ100 Dome size
- Board Lens : 3.6mm
- Vandal Proof Glass

### Option

- Board Lens : 6.0mm



1/3 SONY DSP Super HAD CCD



COLOR



3.6mm BOARD LENS



24pcs IR LED



DAY & NIGHT



AUTO-IRIS

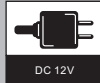

DC 12V

### - DIMENSION -

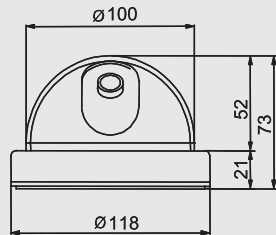
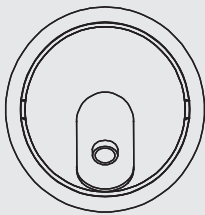

### - SPECIFICATIONS -

| TDE-224S              |  |                         |
|-----------------------|--|-------------------------|
| Signal Format         | NTSC   | PAL                     |
| Horizontal Resolution | 380TV Lines  |                         |
| Image Sensor          | 1/3" SONY DSP Super HAD CCD  |                         |
| Synchronization       | Internal   |                         |
| Video Output          | CVBS : 1.0Vp-p/75Ω   |                         |
| Min. Illumination     | IR LED Off 3Lux(COLOR), IR LED On (0.000Lux)                                 |                         |
| Electronic Shutter    | 1/60~1/100,000 sec Auto  | 1/50~1/100,000 sec Auto |
| Signal to Noise Ratio | 45dB or more (AGC Off)   |                         |
| Gamma                 | 0.45   |                         |
| AGC                   | On   |                         |
| Input Voltage         | DC12V (±10%)   |                         |
| Power Consumption     | MAX 2.0W   |                         |
| DIP Switch Control    | AI/EE Mode, AGC on/off, Flicker less on/off<br>Backlight compensation on/off |                         |
| Lens Option           | 6.0mm  |                         |
| Operating Temperature | -10°C to +55°C   |                         |
| Storage Temperature   | -20°C to +70°C   |                         |
| Operating Humidity    | Under 90% Non-condensing   |                         |
| Storage Humidity      | Under 90% Non-condensing   |                         |
| Dimension             | Φ118 x 73(H)mm   |                         |
| Weight                | 420g   |                         |